

A Pentair Company

Hole Seals, Non-Metallic
Couvertures de trous à vis, non métalliques
Sellos Del Agujero, Nos-metálico

HOFFMAN (World Headquarters)
 2100 Hoffman Way
 Anoka, MN 55303-1745 USA
 (763) 421-2240 Fax: (763) 422-2178
 Customer Service: (763) 422-2211
www.hoffmanonline.com

Canada
HOFFMAN
 111 Grangeway Avenue
 Suite 504
 Scarborough, Ontario M1H 3E9
 (416) 289-2770 Fax: (416) 289-2883
 1-800-668-2500 (Canada only)

Mexico
HOFFMAN MEXICO, S de RL de CV
 Arquímedes No. 33
 Piso 1
 Col. Palmas Polanco
 México, DF
 CP 11560
 P: (55) 5280-1596
 F: (55) 5280-8827 / 5280-8167

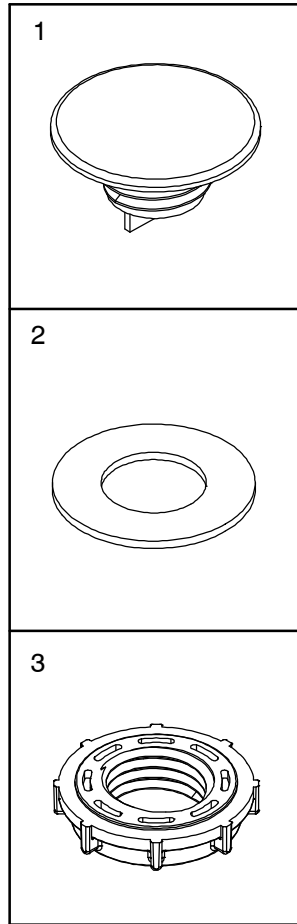

LEGEND				
CATALOG NO.	CONDIUT/PB	MIN. HOLE SIZE	NUT ORIENTATION	TORQUE
ASPB05075NM	1/2"	.859	A	15 in. lbs.
	22.5 mm	.875	A	
	3/4"	1.094	A	
ASPB100125NM	30.5 mm	1.203	A	20 in. lbs.
	1"	1.359	B	
	1 1/4"	1.701	A	
AS150200250NM	1 1/2"	1.951	A	35 in. lbs.
	2"	2.375	B	
	2 1/2"	2.875	A	
AS300350400NM	3"	3.50	A	50 in. lbs.
	3 1/2"	4.00	B	
	4"	4.50	A	

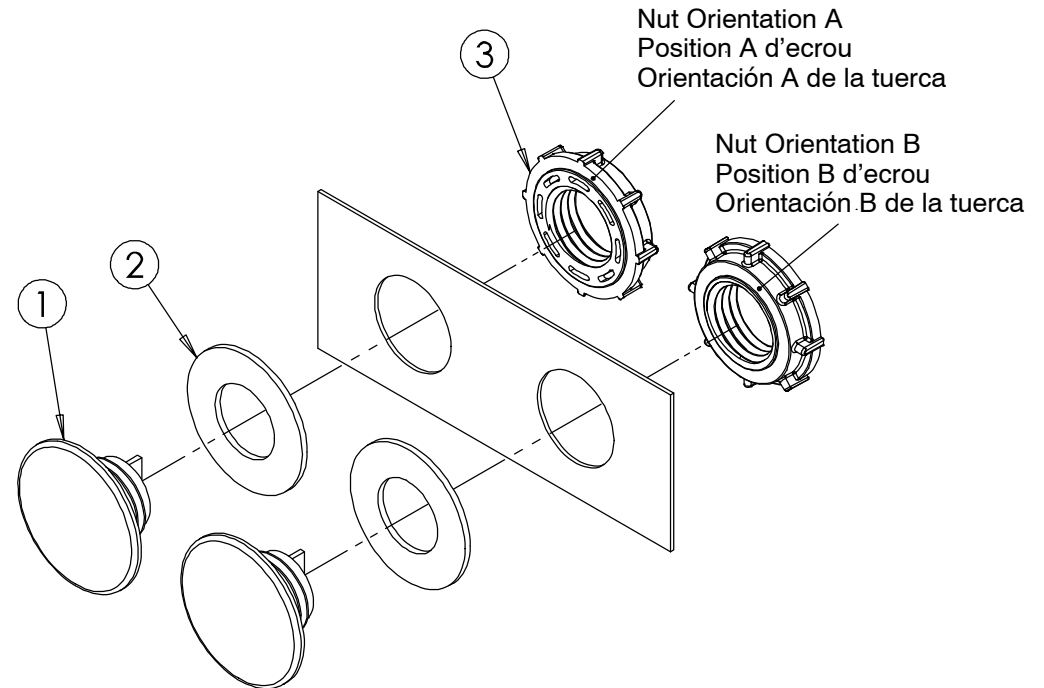

NOTE: Maintains UL/CSA Type 4X when installed per these instructions.
REMARQUE : Maintient le type 4X d'UL/CSA une fois installé par ces instructions.
NOTA: Mantiene el Tipo 4X de UL/CSA cuando está instalado por estas instrucciones.